

AXLE LIFT

SAF INTRADISC plus (INTEGRAL) / INTRADRUM

AL-465-II-DOC

This Bolt-On axle lift is developed for the SAF Intradisc plus (Integral) & Intradrum serie suspensions (IU + IO Suspensions).
 Only for steel hanger bracket systems. (Not for cross member bracket or aluminium hanger bracket).
 Optional **AL-465M-II** version with long stroke air spring. See AL-465-II-APP-1 for systems.
 Direct assembling (KTL coating).

The Bolt-On isn't always suitable when:
 - twin tyres are being used; check clearance between tyres and liftbellow.
 - it concerns a steering axle.

FOR ALL RELEASED SAF SYSTEMS SEE: AL-465-II-APP-1 AND AL-465-II-APP-2 (in combination with tyres)

EXPLANATION

- 1 Assemble lefthand and righthand side.
- 3 Groundclearance G at full axle up travel (loaded without pressure) depends on the airsuspensionsystem and the type of tires. (always check)
- 4 General:
The clearance between the road and the tire when the axle is lifted = axle up travel minus deformation of the tires.
- 5 Not lifted: pressure = 0 bar. Max. operating pressure = 8 bar.
- 6 The airspring is not allowed to hit any other parts. Keep a free diameter of 280 mm for moving parts.
- 7 Air-connection (standard 8 mm, push-in fitting).

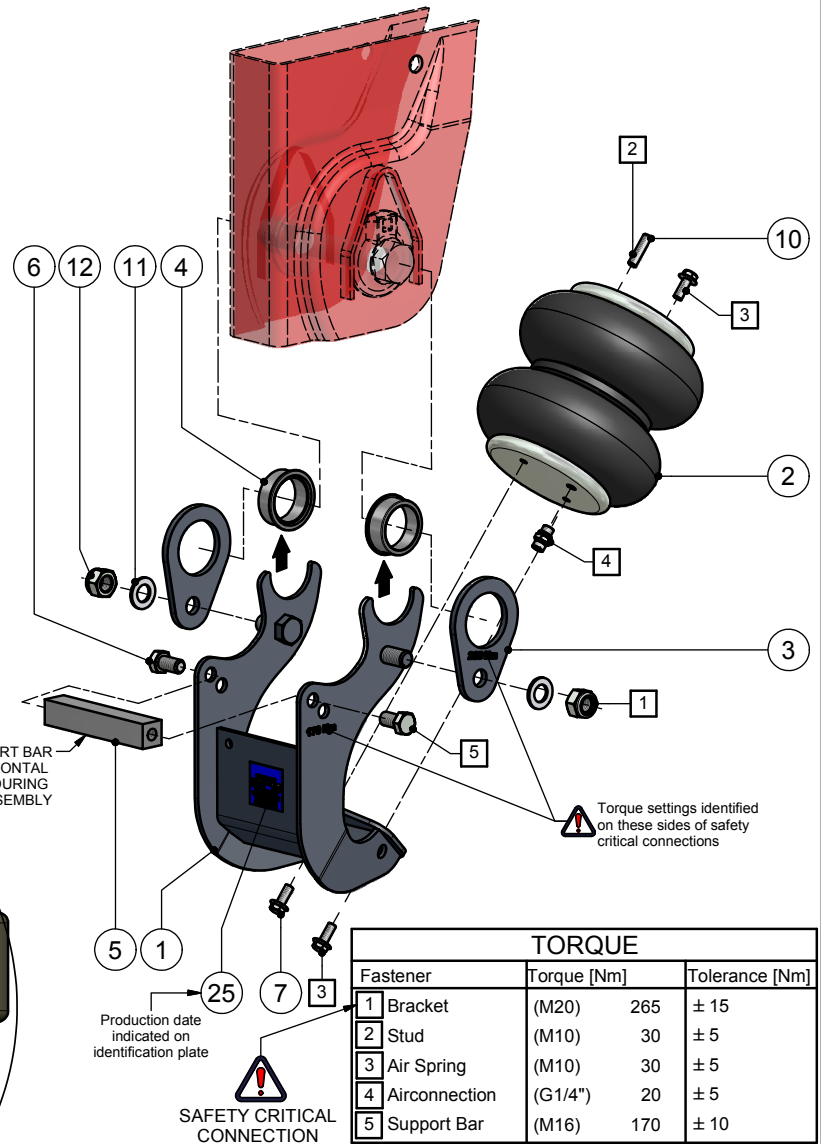
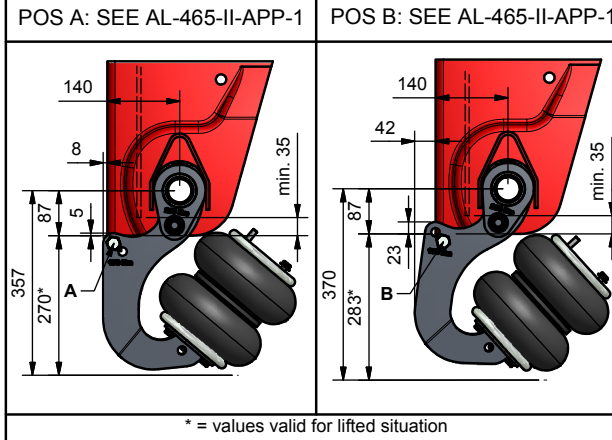

Torque settings identified on these sides of safety critical connections

TORQUE			
Fastener	Torque [Nm]	Tolerance [Nm]	
1 Bracket	(M20) 265	± 15	
2 Stud	(M10) 30	± 5	
3 Air Spring	(M10) 30	± 5	
4 Airconnection	(G1/4") 20	± 5	
5 Support Bar	(M16) 170	± 10	

UNCONTROLLED COPY
NO RIGHTS CAN BE CLAIMED FROM THIS DOCUMENT

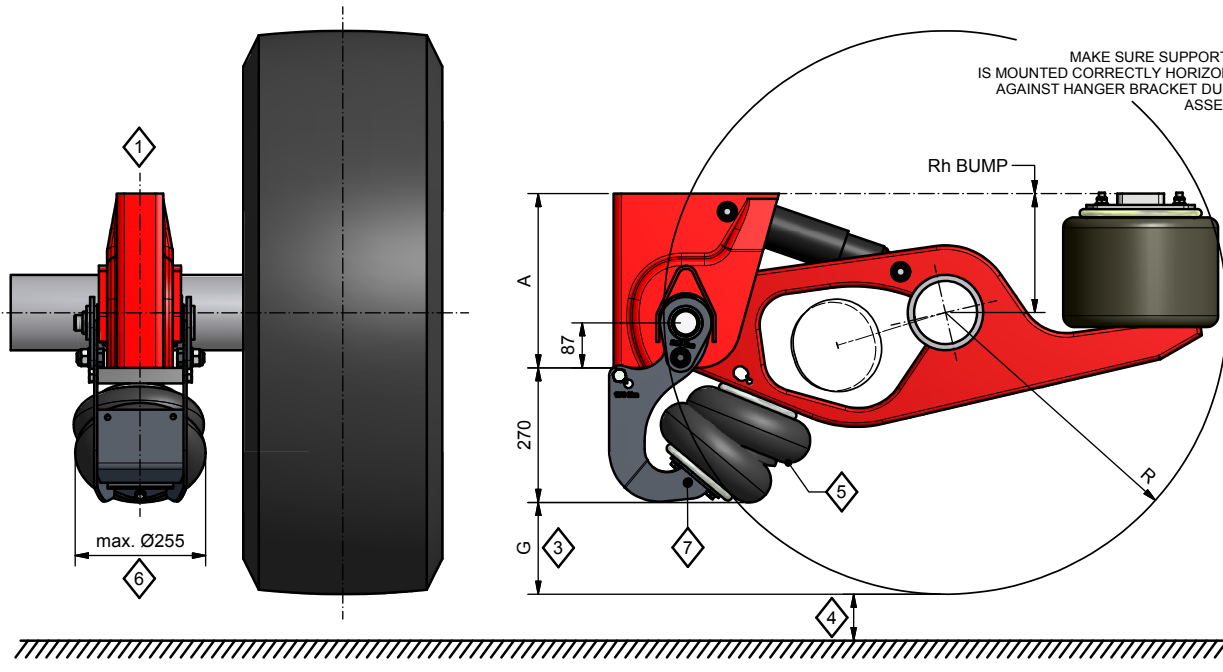

THIS DOCUMENT IS PROPERTY OF VDL WEWELER B.V. COPYING, ANNOUNCING, OR GIVE A THIRD PARTY PERUSAL OF ANY KIND, IS PROHIBITED WITHOUT APPROVAL OF OWNER

VDL Weweler
 VDL WEWELER B.V.
 P.O. BOX 142
 7300 AC APELDOORN
 THE NETHERLANDS

DATE	BY	APP.	PROJECT:
18-11-2008	RTS		WAP08-189
LAST REV.	RTS		WAP10-044
DOC.NR:	WE0006373		REV:
			A