

AXLE LIFT

BPW SL AIR SUSPENSION

AL-459-DOC

This Bolt-On axle lift is developed for the BPW SL air suspensions range since 2005 ("SLM" & "SLO" Series, not for the "SLU" Series). Direct assembling (KTL coating).

It is suitable for systems:

- with disc and drum brakes.
- with single and double leaf springs.
- with 9 t. (120 mm.) or 12 t. (150 mm.) axles.

The axle lift is only for the steel hangerbracket (Not for the cross member bracket).

EXPLANATION

- 1 Assemble lefthand and righthand side.
- 2 Recommendation: Position of nut to outside vehicle.
- 3 Groundclearance G at full axle up travel (loaded without pressure) depends on the airsuspensionsystem and the type of tires. (always check)
- 4 General:
The clearance between the road and the tire when the axle is lifted = axle up travel minus deformation of the tires.
- 5 Not lifted: pressure = 0 bar.
- 6 The airspring is not allowed to hit any other parts. Keep a free diameter of 280 mm for moving parts.
- 7 Air-connection (standard 10 mm)
- 8 The Position of the rubber support is dependent on the type of suspension system, see table for the correct position.

POSITION RUBBER SUPPORT

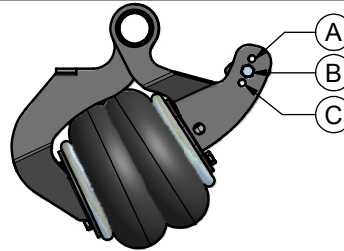

POSITION A: "SLM" Series / Single-leaf spring.
"SLO" Series / Single-leaf spring.

POSITION B: "SLM" Series / Double-leaf spring.

POSITION C: "SLO" Series / Double-leaf spring.

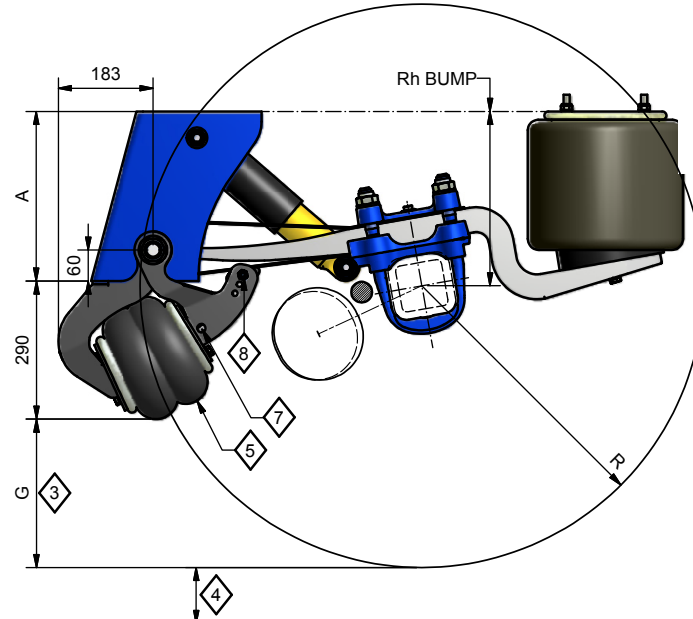
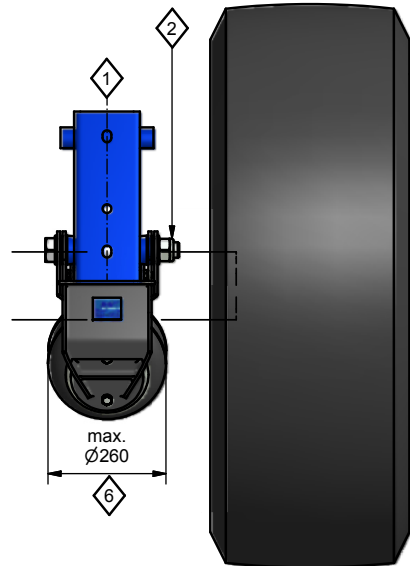
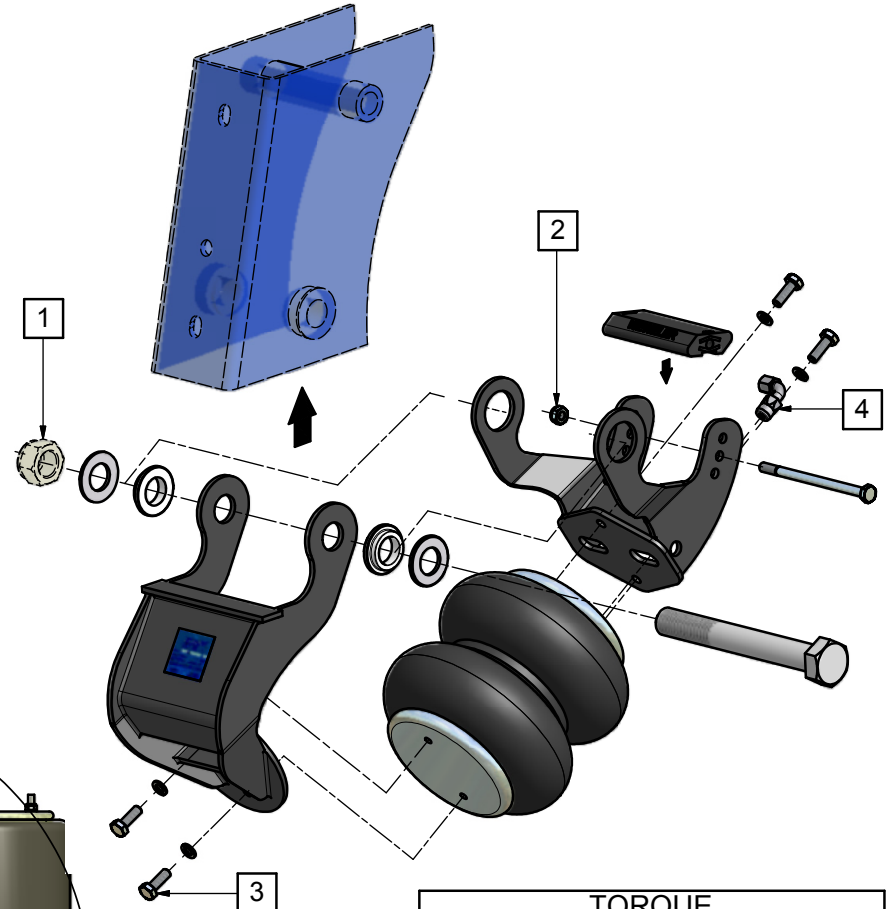

TORQUE

Fastener	Torque [Nm]	Tolerance [Nm]
1 Pivot Bolt (M30) Acc. BPW	Acc. BPW	Acc. BPW
2 Rubber Support (M10)	50	± 10
3 Air Spring (M10)	30	± 10
4 Airconnection (G1/4")	20	± 10

UNCONTROLLED COPY
NO RIGHTS CAN BE CLAIMED FROM THIS DOCUMENT

THIS DOCUMENT IS PROPERTY OF VDL WEWELER B.V. COPYING, ANNOUNCING, OR GIVE A THIRD PARTY PERUSAL OF ANY KIND, IS PROHIBITED WITHOUT APPROVAL OF OWNER				
VDL Weweler	DATE	BY	APP.	PROJECT:
	12-10-2006	RTS		
	LAST REV.	8-9-2010	RTS	WAP10-044
	DOC.NR.	WE0006358		REV: A
VDL WEWELER B.V. P.O. BOX 142 7300 AC APELDOORN THE NETHERLANDS				