

This Weweler Bolt-On axle lift is developed for Weweler air suspension systems with adjustable wearing plates (Euro 2000 hangerbracket). Direct assembling (KTL coating).

The Bolt-On axle lift isn't suitable when:

- the suspension system has a stroke of more than 220 mm.
- it concerns a steering axle.

EXPLANATION

- 1 Assemble lefthand and righthand side.
- 2 Recommendation: Position of nut to outside vehicle.
- 3 Groundclearance G at full axle up travel (loaded without pressure) depends on the airsuspensionsystem and the type of tires. (always check)
- 4 General:
The clearance between the road and the tire when the axle is lifted = axle up travel minus deformation of the tires.
- 5 Not lifted: pressure = 0 bar.
- 6 The airspring is not allowed to hit any other parts. Keep a free diameter of 280 mm for moving parts.
- 7 Air-connection (standard 10 mm)
- 8 The position of the rubber support is dependent on the type of suspension system, contact Weweler for the correct position.

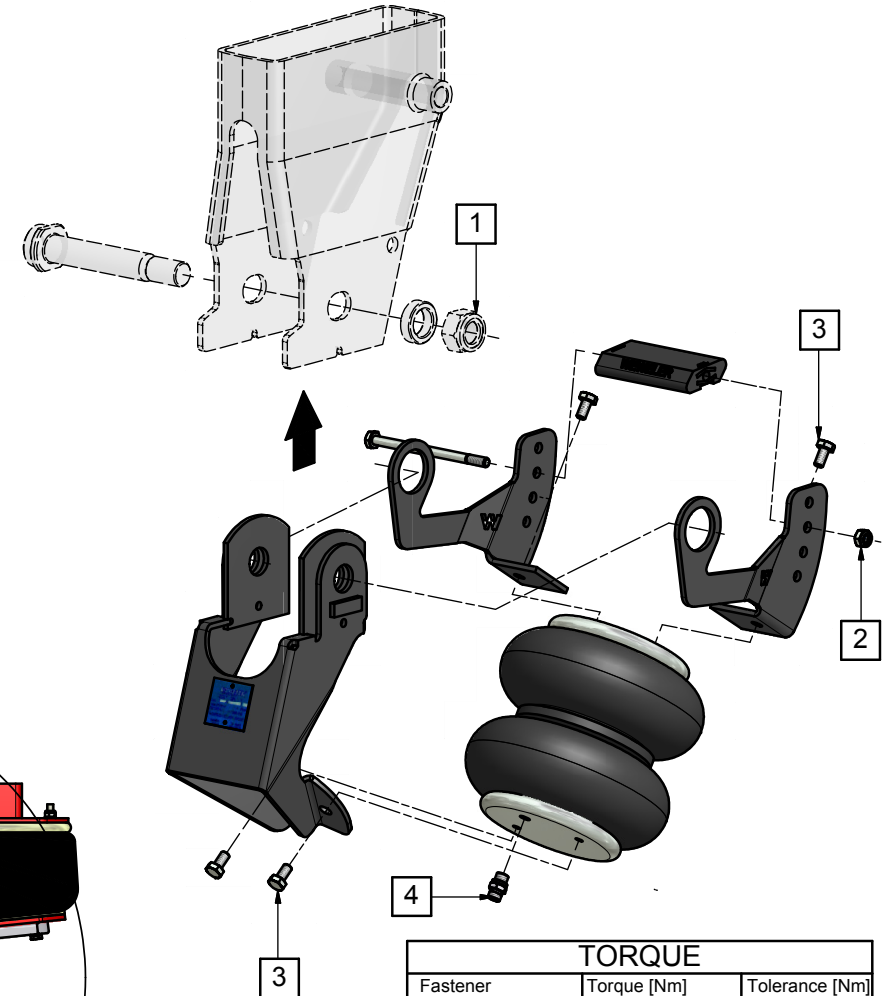

TORQUE			
Fastener	Torque [Nm]	Tolerance [Nm]	
1 Pivot Bolt	(M27/M30)	SEE IM-052	
2 Rubber Support	(M10)	50	± 10
3 Air Spring	(M10)	30	± 10
4 Air-connection	(G1/4")	20	± 10

UNCONTROLLED COPY
NO RIGHTS CAN BE CLAIMED FROM THIS DOCUMENT

THIS DOCUMENT IS PROPERTY OF VDL WEWELER B.V. COPYING, ANNOUNCING, OR GIVE A THIRD PARTY PERUSAL OF ANY KIND, IS PROHIBITED WITHOUT APPROVAL OF OWNER

VDL Weweler VDL WEWELER B.V. P.O. BOX 142 7300 AC APELDOORN THE NETHERLANDS	DATE	BY	APP.	PROJECT:
	21-2-2006	RTS		WAP05-117
LAST REV.	1-9-2010	RTS		WAP10-044
DOC.NR:	WE0015861			REV:

